



**Cordless Telescopic Pole Saw**  
**User Manual and Operating Instructions**  
**Item Number: 21389**



Preferred Living  
PreferredLiving.com  
2001 Sporty's Drive  
Batavia, OH 45103  
PreferredLiving@Sportys.com  
1-800-776-7897

**Fig.1**

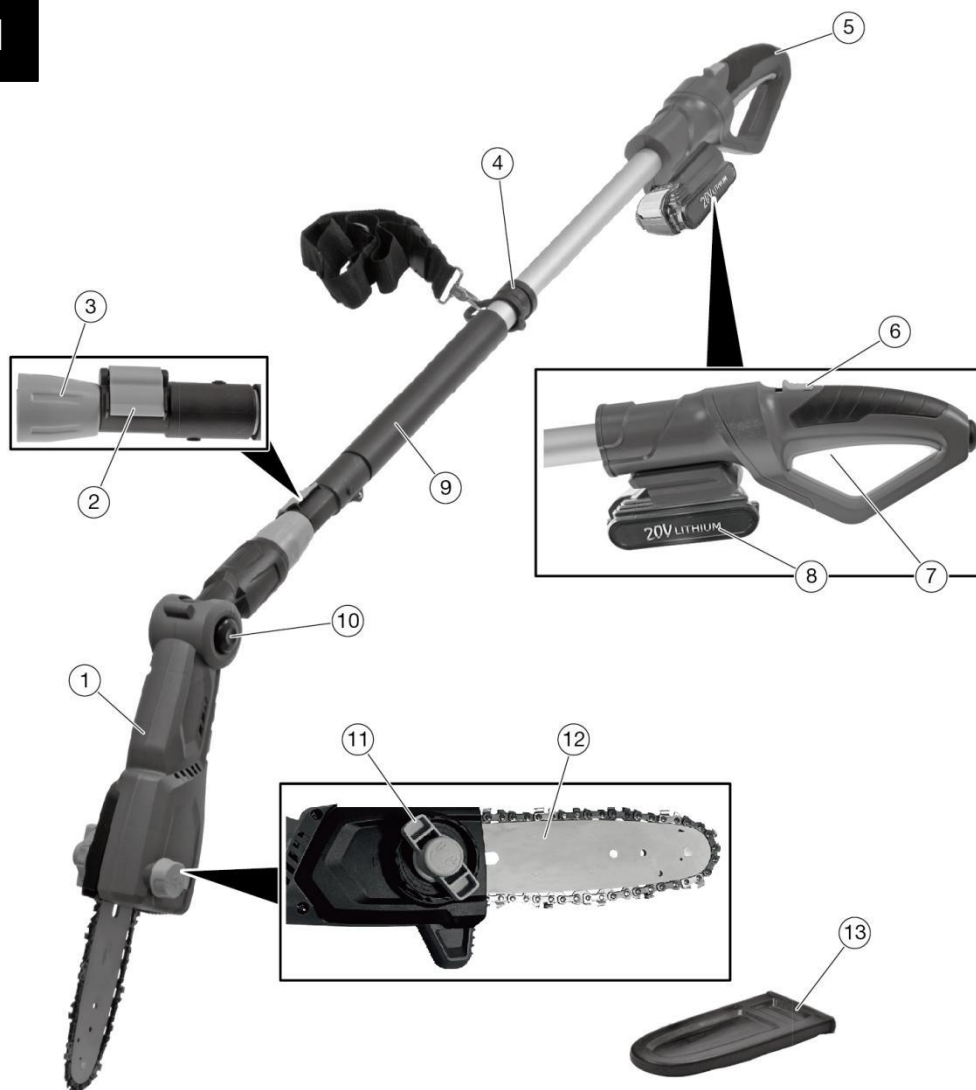

**Fig.2**



**Fig.3**



**Fig.4**

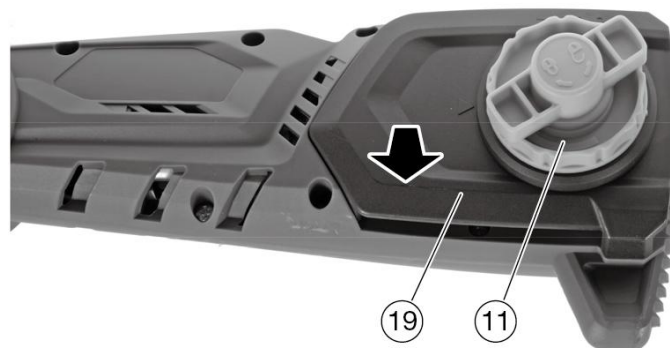

**Fig.5**

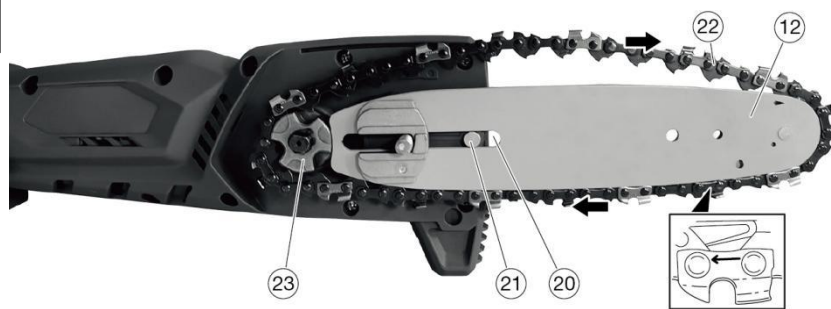

**Fig.6**

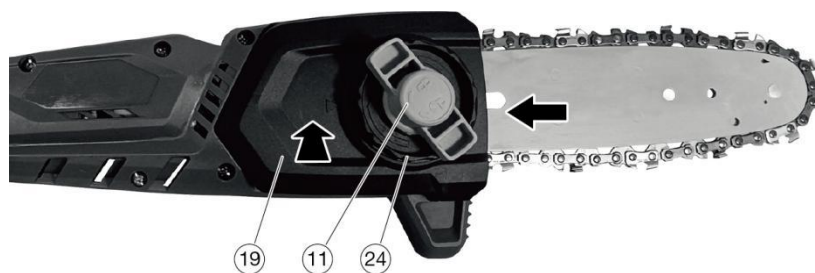

**Fig.7**

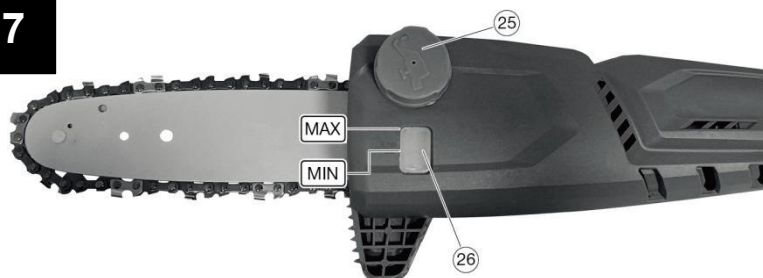

**Fig.8**



**Fig.9**



## Safety warnings

All Operators Must Read These Instructions Before Use. These instructions are for your safety. Please read through them thoroughly before use and retain them for future reference.

### General power tool safety warnings



**WARNING!** Read all safety warnings and all instructions. Failure to follow the warnings and instructions may result in electric shock, fire and/or serious injury. Save all warnings and instructions for future reference.  
The term “power tool” in the warnings refers to your battery-operated (cordless) power tool.

## Before you begin...

### Intended use

Pruning saw: This device may only be used with the approved original cutting chain for sawing wood. This product is not intended for commercial use. Generally acknowledged accident prevention regulations and enclosed safety instructions must be observed. Only perform work described in these instructions for use. Any other use is improper. The manufacturer will not assume responsibility for damage resulting from such use.

### What are the meanings of the symbols used?

Danger notices and information are clearly marked throughout these instructions for use.

The following symbols are used:



**WARNING! Direct danger to life and risk of injury!** Directly dangerous situation that may lead to death or severe injuries.

**WARNING! Probable danger to life and risk of injury!** Generally dangerous situation that may lead to death or severe injuries.

**WARNING! Possible risk of injury!** Dangerous situation that may lead to injuries.

**NOTICE! Risk of damage to the device!** Situation that may lead to property damage.

**Note:** Information to help you reach a better understanding of the processes involved.

These symbols identify the required personal protection equipment:



### Work area safety

- **Keep work area clean and well lit.** Cluttered and dark areas invite accidents.
- **Do not operate power tools in explosive atmospheres, such as in the presence of flammable liquids, gases or dust.** Power tools create sparks which may ignite the dust or fumes.
- **Keep children and bystanders away while operating a power tool.** Distractions can cause you to lose control.

### Electrical safety

- Do not expose power tools to rain or wet conditions. Water entering a power tool will increase the risk of electric shock.
- If operating a power tool in a damp location is unavoidable, use a residual current device (RCD) protected supply. Use of an RCD reduces the risk of electric shock.

### Personal safety

- **Stay alert, watch what you are doing and use common sense when operating a power tool. Do not use a power tool while you are tired or under the influence of drugs, alcohol or medication.** A moment of inattention while operating power tools may result in serious personal injury.
- **Use personal protective equipment. Always wear eye protection.** Protective equipment such as dust mask, nonskid safety shoes, hard hat, or hearing protection used for appropriate conditions will reduce personal injuries.
- **Prevent unintentional starting. Ensure the switch is in the off-position before connecting to power source and/or battery pack, picking up or carrying the tool.** Carrying power tools with your finger on the switch or energizing power tools that have the switch on invites accidents.
- **Remove any adjusting key or wrench before turning the power tool on.** A wrench or a key left attached to a rotating part of the power tool may result in personal injury.
- **Do not overreach. Keep proper footing and balance at all times.** This enables better control of the power tool in unexpected situations.
- **Dress properly. Do not wear loose clothing or jewelry. Keep your hair, clothing and gloves away from moving parts.** Loose clothes, jewelry or long hair can be caught in moving parts.

### Power tool use and care

- **Do not force the power tool. Use the correct power tool for your application.** The correct power tool will do the job better and safer at the rate for which it was designed.
- **Do not use the power tool if the switch does not turn it on and off.** Any power tool that cannot be controlled with the switch is dangerous and must be repaired.
- **Disconnect the plug from the power source and/or the battery pack from the power tool before making any adjustments, changing accessories, or storing power tools.** Such preventive safety measures reduce the risk of starting the power tool accidentally.
- **Store idle power tools out of the reach of children and do not allow persons unfamiliar with the power tool or these instructions to operate the power tool.** Power tools are dangerous in the hands of untrained users.
- **Maintain power tools. Check for misalignment or binding of moving parts, breakage of parts and any other condition that may affect the power tool's operation. If damaged, have the power tool repaired before use.** Many accidents are caused by poorly maintained power tools.

- **Keep cutting tools sharp and clean.** Properly maintained cutting tools with sharp cutting edges are less likely to bind and are easier to control.
- **Use the power tool, accessories and tool bits etc. in accordance with these instructions, taking into account the working conditions and the work to be performed.** Use of the power tool for operations different from those intended could result in a hazardous situation.

#### **Battery tool use and care**

- **Recharge only with the charger specified by the manufacturer.** A charger that is suitable for one type of battery pack may create a risk of fire when used with another battery pack.
- **Use power tools only with specifically designated battery packs.** Use of any other battery packs may create a risk of injury and fire.
- **When battery pack is not in use, keep it away from other metal objects, like paper clips, coins, keys, nails, screws or other small metal objects, that can make a connection from one terminal to another.** Shorting the battery terminals together may cause burns or a fire.
- **Battery chemicals cause serious burns** – Never let a damaged battery pack contact the skin, eyes or mouth. If a damaged battery pack leaks battery chemicals, use rubber or neoprene gloves to safely dispose of it. If skin is exposed to battery fluids, wash the affected area with soap and water and rinse with vinegar. If eyes are exposed to battery chemicals, immediately flush with water for 20 minutes and seek medical attention. Remove and dispose of contaminated clothing.
- **Do not open the rechargeable battery.** The rechargeable battery can be damaged by improper handling.
- **Do not expose the rechargeable battery to heat, fire, water and humidity.** There is a danger of explosion.
- **Vapors may escape in case of damage or improper use of the rechargeable battery. Provide good ventilation and seek medical assistance in case any symptoms occur.** The vapors can irritate your respiratory tract and cause illness.

#### **Safety information for chargers**

- **Keep the charger away from rain and wet.** The risk of electric shock increases if water penetrates a charging device.
- **Keep the charging device clean.** Soiling involves the danger of an electric shock.
- **Check the charging device, cable and plug before each use.** Do not use the charging device if you detect any damage.
- **Do not open the charging device yourself and only have it repaired by qualified professionals and only with original spare parts.** Damaged charging devices, cables and plugs increase the risk of electric shock.
- **Do not use the charging device on easily flammables items (e.g. paper, textiles etc.) or in combustible atmospheres.** There is a danger of fire due to the heating of the charging device during the charging process.
- **Supervise children and make sure that they do not play with the charger. Children and persons with mental or physical restrictions may only use the charger under supervision or after having been instructed how to use it.** Careful instruction reduces the risk of incorrect operation and injuries.

## Service

- Have your power tool serviced by a qualified repair person using only identical replacement parts. This will ensure that the safety of the power tool is maintained.

## Chain saw safety warnings

- **Keep all parts of the body away from the saw's chain when the chain saw is operating. Before you start the chain saw, make sure the saw chain is not contacting anything.** A moment of inattention while operating chain saws may cause entanglement of your clothing or body with the saw chain.
- **Always hold the chain saw with your right hand on the rear handle and your left hand on the front handle.** Holding the chain saw with a reversed hand configuration increases the risk of personal injury and should never be done.
- **Hold the power tool by insulated gripping surfaces only, because the saw chain may contact hidden wiring.** Saw chains contacting a "live" wire may make exposed metal parts of the power tool "live" and could give the operator an electric shock.
- **Hold the power tool by insulated gripping surfaces only, because the saw chain may contact hidden wiring or its own cord.** Saw chains contacting a "live" wire may make exposed metal parts of the power tool "live" and could give the operator an electric shock.
- **Wear safety glasses and hearing protection. Further protective equipment for head, hands, legs and feet is recommended.** Adequate protective clothing will reduce personal injury by flying debris or accidental contact with the saw chain.
- **Do not operate a chain saw in a tree.** Operation of a chain saw while up in a tree may result in personal injury.
- **Always keep proper footing and operate the chain saw only when standing on fixed, secure and level surface.** Slippery or unstable surfaces such as ladders may cause a loss of balance or control of the chain saw.
- **When cutting a limb that is under tension be alert for spring back.** When the tension in the wood fibers is released, the spring-loaded limb may strike the operator and/or throw the chain saw out of control.
- **Use extreme caution when cutting brush and saplings.** The slender material may catch the saw chain and be whipped toward you or pull you off balance.
- **Carry the chain saw by the front handle with the chain saw switched off and away from your body. When transporting or storing the chain saw always fit the guide bar cover.** Proper handling of the chain saw will reduce the likelihood of accidental contact with the moving saw chain.
- **Follow instructions for lubricating, chain tensioning and changing accessories.** Improperly tensioned or lubricated chain may either break or increase the chance for kickback.
- **Keep handles dry, clean, and free from oil and grease.** Greasy, oily handles are slippery causing loss of control.
- **Cut wood only. Do not use chain saw for purposes not intended. For example: do not use chain saw for cutting plastic, masonry or non-wood building materials.** Use of the chain saw for operations different than intended could result in a hazardous situation.
- Before starting the power tool, you must ensure that the chain is free from foreign objects.
- Always cut at full motor power and keep the speed constant.



### **Safety information for pole-mounted chain saws**

- Make sure that the working area is free from obstacles. Do not allow the tip of the sawing rail to come into contact with a fence, branch or similar when operating the product.
- Do not use the product on ladders or unstable surfaces. Stand firmly on the ground with both feet to prevent loss of balance.
- To protect yourself against electric shock you should never use the product closer than 10 m from overhead power lines.
- To protect yourself against falling branches you should not stand directly underneath the parts to be cut. Do not hold the product at an angle of more than 60° to the ground.

**Causes and operator prevention of kickback:** Kickback may occur when the nose or tip of the guide bar touches an object, or when the wood closes in and pinches the saw chain in the cut. Tip contact in some cases may cause a sudden reverse reaction, kicking the guide bar up and back towards the operator. Pinching the saw chain along the top of the guide bar may push the guide bar rapidly back towards the operator. Either of these reactions may cause you to lose control of the saw which could result in serious personal injury. Do not rely exclusively upon the safety devices built into your saw. As a chain saw user, you should take several steps to keep your cutting jobs free from accident or injury. Kickback is the result of tool misuse and/or incorrect operating procedures or conditions and can be avoided by taking proper precautions as given below:

- **Maintain a firm grip, with thumbs and fingers encircling the chain saw handles, with both hands on the saw and position your body and arm to allow you to resist kickback forces.** Kickback forces can be controlled by the operator, if proper precautions are taken. Do not let go of the chain saw.
- **Do not overreach and do not cut above shoulder height.** This helps prevent unintended tip contact and enables better control of the chain saw in unexpected situations.
- **Only use replacement bars and chains specified by the manufacturer.** Incorrect replacement bars and chains may cause chain breakage and/or kickback.
- **Follow the manufacturer's sharpening and maintenance instructions for the saw chain.**

Decreasing the depth gauge height can lead to increased kickback.

### **Safety warnings for battery packs**

1. Do not attempt to charge the battery pack with any other charger than the one supplied. The charger and battery pack supplied with it are specifically designed to work together.
2. Charge and store the battery pack in an ambient temperature of 18 - 24°C (65 - 75°F) to ensure the longest battery life and best performance. Do not charge or store the battery pack in temperatures below 0°C (32 °F) and above 45°C (113°F).
3. Small leakage of liquid from the battery pack may occur under extreme usage or temperature conditions. However, if the outer seal is broken and this leakage comes into contact with your skin wash the affected area quickly with water. If the leakage gets in your eyes flush your eyes with clean water for a minimum of 10 minutes and seek immediate medical attention.
4. Never attempt to open the battery pack for any reason. If the plastic housing of the battery pack breaks open or cracks, immediately discontinue its use and do not recharge it.
5. Do not store or carry a spare battery pack in a pocket or toolbox or any other place where it may come into contact with metal objects. The battery pack may be short-circuited causing damage to the battery pack, burns or a fire.
6. Do not pierce the battery with nails, strike the battery with a hammer, step on the battery or otherwise subject it to strong impacts or shocks.
7. Protect the battery pack against heat. Do not place the battery in direct sunlight or use or store the battery inside cars in hot weather. Doing so may cause the battery to generate heat, explode or ignite.
8. Never try to charge a battery pack that is cracked or damaged in any other way. There is a danger of electric shock or electrocution.

**WARNING: Only use genuine batteries.**

Use of non-genuine batteries, or batteries that have been altered, may result in the battery bursting causing fires, personal injury, and damage. It will also void the warranty for the tool and charger.

**Tips for maintaining maximum battery life**

1. Charge the battery cartridge before completely discharging. Always stop tool operation and charge the battery cartridge when you notice less tool power.
2. Never recharge a fully charged battery cartridge. Overcharging shortens the battery service life.
3. Charge the battery cartridge with room temperature at 10 °C – 40 °C (50 °F – 104 °F). Let a hot battery cartridge cool down before charging it.
4. Charge the battery cartridge if you do not use it for a long period (more than six months).

**Important safety instructions for Charger**

1. Use only the voltage specified on the charger.
2. Before charging the battery, first connect the power cable to the outlet and then connect the battery pack to the charger. After the battery has been fully charged, remove the battery pack from the charger and disconnect charger from the outlet.
3. This device is for indoor use only. Water, rain, or moisture should be avoided. Any damage caused by improper use is the sole responsibility of the user. The rules for avoiding accidents and the accompanying safety instructions must be observed.
4. The charger charges the following battery packs.

Battery charger Model number.	Battery pack	
	Model	Volt
8066-CHA	DC11-2100500U	100-240V AC,50/60HZ
<ul style="list-style-type: none"><li>• Do not charge non-rechargeable batteries with this device.</li></ul>		

5. SAVE THESE INSTRUCTIONS. This manual contains important safety information and instructions for using the battery charger.
6. Do not place any object on top of the charger as it could cause overheating. Do not place the charger near any heat source.





**Additional safety information**

- It is recommended that the user is instructed by a qualified specialist with regard to the operation of the chain saw and the use of safety equipment based on practical examples prior to first commissioning.
- This product is not intended to be used by persons (including children) or who are limited in their physical, sensory or mental capacities or who lack experience and/or knowledge of the product unless they are supervised, or have been instructed on how to use the product, by a person responsible for their safety.
- Children should be supervised to ensure that they do not use the product as a toy.
- Children and adolescents are not allowed to operate the chain saw. The same applies to persons who are not or not well enough acquainted with the chain saw.
- The operating instructions should always be within easy reach.
- Persons suffering from fatigue or who are not physically fit must not operate the chain saw.

- **Avoid uncontrolled restarting.** Switch the tool off when the power supply is interrupted, for example, by a power failure or pulling the plug.
- **Keep the handles dry and free from grease.** Slippery handles can cause accidents.
- **Keep a firm hold of the electrical tool with both hands while working and make sure you are standing firmly.** The electrical tool is more safely guided using two hands.
- **Always comply with the all applicable domestic and international safety, health, and working regulations.**

Inform yourself before you start work about the regulations that apply at the site of the device.

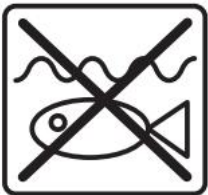
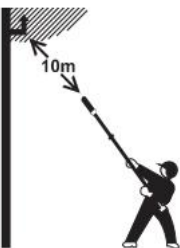
- **Do not leave tools, objects or cable laying around in the vicinity of the device.** If you stumble, you may injure yourself on the power tool.
- Make sure that all safety facilities and handles are mounted when using the product.
- Never attempt to operate an incompletely mounted product or a product with impermissible modifications.
- Wait until the electrical tool has come to a standstill before putting it down.
- **Do not use any accessory that has not been provided and recommended by the manufacturer specially for this electrical tool.** Just because the accessories can be fixed on your electrical tool, no secured use is ensured.
- Remember that moving parts may also be located behind ventilation and venting slots.
- Symbols located on your appliance may not be removed or covered. Replace any information on your appliance immediately that have become illegible.

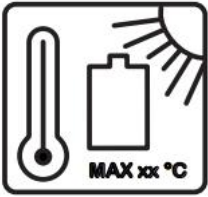
	Before putting the unit into operation, read and observe the instructions for use.		Do not dispose of a battery pack with the household waste!
	Protect the unit from wet conditions. Store in a dry place.		Do not dispose of a battery pack in water!
	Risk of death through electric shock! Maintain minimum distance for electrical overhead lines: 10 m minimum distance		Do not burn the battery pack!
	Only re-charge the battery pack indoors.		Do not expose the battery pack to sunlight or increased temperatures!

## Risks caused by vibrations



**WARNING! Risk of injury due to vibrations!** Vibrations may, in particular for persons with circulation problems, cause damage to blood vessels and/or nerves.

If you notice any of the following symptoms, stop working immediately and consult a doctor. Numbness of body parts, loss of sense of feeling, itching, pins and needles, pain, changes in skin color.

The vibration values specified in the technical data represent the main uses of the device. The actual existing vibrations during use may deviate from these as a result of the following factors:

- Incorrect use of the product;
- Unsuitable tools inserted;
- Unsuitable material;
- Insufficient maintenance.

You can reduce the risks considerably by following the tips below:

- Maintain the device in accordance with the instructions in the operating instructions.
- Avoid working at low temperatures.
- When it is cold, make sure your body and your hands, in particular, are kept warm.
- Take regular breaks and move your hands at the same time to promote circulation.

## Personal protective equipment/sensible clothing

When cutting, wear the following protective equipment:

	Eye protection: wrap-around goggles/protective visor on the helmet
	Ear protection: earplugs/ear muffs
	Head protection: safety helmet with visor
	Foot protection: safety shoes with gripping soles, steel caps and leg protection
	Hand protection: protective chainsaw gloves
	Clothing: safety overalls (cut-proof), Safety jacket (cut-proof)

Avoid with your clothing that you get caught on something:

- Wear only close-fitting clothing!
- Do not wear any jewelry!
- If you have long hair, wear a hair net!

## Your appliance at a glance (Fig. 1&2)

1. Drive unit for chain saw	10. Unlock button for drive unit
2. Lock for length setting	11. Quick locking device for saw bar
3. Unlock nut for drive unit	12. Saw bar
4. Shoulder strap lug	13. Protective cover
5. Grip for rear hand	14. Battery capacity indicator
6. Switch-on safety lock	15. Push button for capacity display
7. On/Off switch	16. Battery Locking & release button
8. Battery pack	17. Battery charger Control lights
9. Grip for front hand	18. Battery charger

### What is included

- Drive unit for chain saw
- Telescopic rod
- Protective cover
- Saw bar
- Saw chain
- Instructions for use
- 1\*2.0Ah Battery pack
- Battery charger

## Technical data

21389	
Voltage	20V DC
Battery type	Lithium-Ion
Battery capacity	2000mAh
Charging time	3-5 hours
Idling speed	1800/min
Length of the saw bar	8 inch
Cutting speed	4,5 m/s
Oil tank capacity 100 ml	100 ml
Noise pressure level(LPA)*	77,8 dB(A)(K = 3 dB(A))
Sound power level(LWA)*	87,8 dB(A)(K = 2,72 dB(A))
Vibration**	
• Grip for front hand	2,55 m/s <sup>2</sup> (K = 1,5 m/s <sup>2</sup> )
• Grip for rear hand	2,48 m/s <sup>2</sup> (K = 1,5 m/s <sup>2</sup> )
Saw bar	• OREGAN
Saw chain	• OREGAN

### Appropriate chain oil

**NOTICE! Risk of damage to the device!** Under no circumstances should you use old oil to grease the saw chain! This can cause damage to the oil pump, saw bar and chain!

Use only special saw chain oils with good adhesion properties. Since the saw chain oil can penetrate the environment during operation, biologically-degradable special vegetable-based saw chain oils should be used.

### Installation



**WARNING! Risk of injury during operation!** Improperly mounted parts can cause severe and even fatal injuries when using the device! This device may only be commissioned if all parts are mounted completely and tightly and no part is damaged!

- Therefore, read the whole chapter before you assemble the parts!
- Assemble the parts carefully and completely.
- Use tools when their use is suggested.

**WARNING! Risk of injuries due to cuts!** The teeth of the saw chain are very sharp! Protective gloves must be worn for all work on the chain.

**WARNING! Risk of injury!** An improperly mounted saw chain causes uncontrolled cutting behavior of the device! When assembling the chain, heed the prescribed running direction!

#### Fitting the shoulder strap (Fig.3)

- Hook the shoulder strap into the lug (4).

#### Assembling telescopic rod (Fig.3)

- Fit the drive unit (1) onto the telescopic rod (9) and let it lock into place.
- Screw in the locking nut (3) towards.

#### Assembling the saw bar and saw chain

- Loosen the nut (11) on the chain wheel guard (19) and remove chain wheel guard. **(Fig.4)**
- Place Saw bar (12) on the guide rail (21) with the guide groove (20). Place the saw chain (22) around the chain wheel (23). Heed the assembly direction. Place the saw chain (22) around the saw bar (12). **(Fig.5)**

**Note:** When attaching the chain, heed the correct position of the guide groove (saw bar).

- Attach the chain wheel guard (19). Tighten the fastening nut (11) only slightly. **(Fig.6)**

#### Tensioning the saw chain (Fig.6)

- Tighten the tension ring (24) until the chain lies on the underside of the saw bar.
- Tighten the fastening nut (11).

#### Letting the saw chain run in

During the run-in time, re-tension the saw chain and rail after a maximum of 5 cuts.

#### Checking the tensioning of the saw chain

The saw chain is tensioned correctly if it lies close against the underside of the saw bar and can be moved easily by hand. Readjust tension of the saw chain when necessary (► *Re-tensioning the saw chain*).

#### Checking the chain greasing

The device may not be used without sufficient chain greasing. Insufficient greasing reduces the service life of the device.

- Check the oil quantity in the tank.
- Start the device.

– Hold the running saw chain approx. 15 cm over a suitable surface for a time (15 s).

If there is sufficient chain greasing, the oil spraying off of the saw chain will form a slight trail.

#### **Filling up saw chain oil**

##### **NOTICE! Environmental damage!**

Since the saw chain oil can penetrate the environment during operation, biologically-degradable special vegetable-based saw chain oils should be used. (Fig.7)

- Lay device securely with the tank cover (25) upwards.
- Before opening, clean the tank cover and the filler neck if necessary.
- Slowly open and remove the tank cover.
- Carefully fill up the saw chain oil. Do not spill!
- Read the oil level at the inspection glass (26). The oil stand must be placed between **[MIN]** and **[MAX]**.
- Tighten the tank cover by hand.
- If you have spilled any saw chain oil, be sure to wipe it up.

## **Operation**

#### **Charging the battery pack**

**WARNING! Risk of injury!** Comply with all safety instructions when handling rechargeable devices.

**NOTICE! Risk of damage to the unit!** Do not allow the battery pack to deep discharge.

**NOTICE! Risk of damage to the unit!** Do not press the On/Off switch after the device has deactivated automatically.

**Note:** The Li-Ion battery pack can be charged at any time without affecting the lifetime of the unit.

Interrupting the

charging process will not damage the battery pack.

**Note:** If the battery is fully loaded, the charger automatically switches over to the maintenance charge function. The battery can thus remain in the charger permanently.

The battery pack must be charged prior to the first start-up (charging time: ► *Technical Data*)

- Press in the locking button (16) and remove the battery from the device. (Fig.8)
- Insert the battery pack into the battery charger. Plug the charger into the power supply. The charging status is displayed by the control lights (14). Slot the battery pack into the device and make sure it clicks into place correctly. (Fig.9)
- After the completion of charging, the LED will then turn green

#### **Battery capacity indicator**

Press the switch for the battery capacity indicator (15). The battery capacity indicator (14) shows the charge status of the battery using 3 LEDs. (Fig.2)

All 3 LEDs are lit:

The battery is fully charged.

2 LED(s) are lit:

The battery has an adequate remaining charge.

1 LED are lit:

The battery has low capacity and requires charging.

**Note:** The battery pack can become a little warm during the charging. This is normal.

### Adjusting the length of the telescopic rod (Fig.3)

- Loosen the locking lever (2). Pull out telescopic rod (9) of desired length.
- Tighten the locking lever (2) again.

### Adjusting working position of the drive unit (Fig.1)

- Press the unlock button (10) and bend drive unit (1) until it clicks into place.

### Check before use!



**WARNING! Attention, danger of injury!** Do not operate the appliance unless you did not find any faults.

If a part has become defective, make sure to replace it before you use the appliance again.

Check the safety devices and the safe condition of the appliance:

- Check all parts for tightness.
- Check the appliance for visual damage: broken parts, cracks, etc.

### Switching on/off (Fig.1)

- Firmly hold product with hands and use shoulder strap.
- Switching on: Push switch-on safety lock (6) forward and simultaneously press On/ Off switch (7).
- Switching off: Release On-Off switch (7).

### Operating as branch saw



Before use, familiarize yourself sufficiently with the sawing technique for chain saws.

You will find information about this in the trade literature. We recommend that you attend suitable training sessions. The notes here serve only as a complement!

### Correct posture



**WARNING! Risk of injury!** Never work on unstable surfaces! Never work while standing on a ladder!

Do not work bent too far forward! Only use the device under favorable weather and site conditions!

- Stand with both legs securely on the ground.
- Heed obstacles in the work area.
- While you are working, always hold the device fast with both hands!
- The shoulder strap is be carried on left shoulder!
- Hold the device:
  - with the left hand on the saw pole
  - with the right hand on the handle.
  - balanced in a secure position.

### Here's how to saw correctly!



**WARNING! Risk of injury!** Always switch the motor off before you put the device down!

- Search the work area and remove objects which are in your way.
- When you begin work, check the safety of the device (► *Check before use!*).
- Take the device in both hands as instructed.



### **Risk of kickback!**

Kickbacks occur if the upper edge or tip of the saw bar touch wood or other hard objects. The device is thrown with high energy back and forth, which can cause extremely severe injuries.

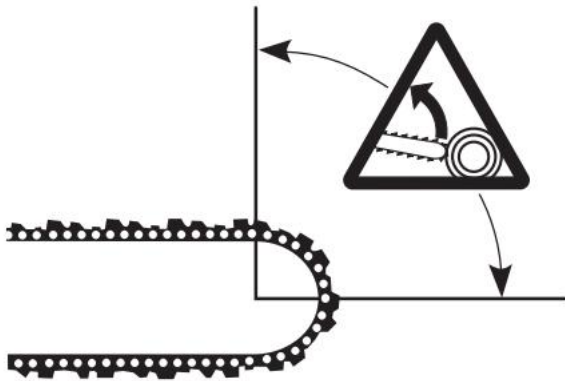

Avoid letting the area of the saw bar depicted on the right touch wood or other hard objects. Only a careful and correct working method can reduce the risk of a kickback reliably!

### **Basic work technique**



**WARNING! Risk of injury!** This section treats the basic work technique when handling the device. The information provided here does not replace the many years of training and experience of a professional. Do not perform any work for which you are not sufficiently qualified! Thoughtless handling of the device can cause severe or even fatal injuries!

#### **Before each use**

1. Check the switch-on safety lock and start button to ensure they are functioning correctly.
2. Check whether all handles are free of oil.
3. Check whether all parts of the device are present, firmly attached and undamaged.
4. Check the chain tensioning.

### **Sawing technique**

#### **Pulling sawing**

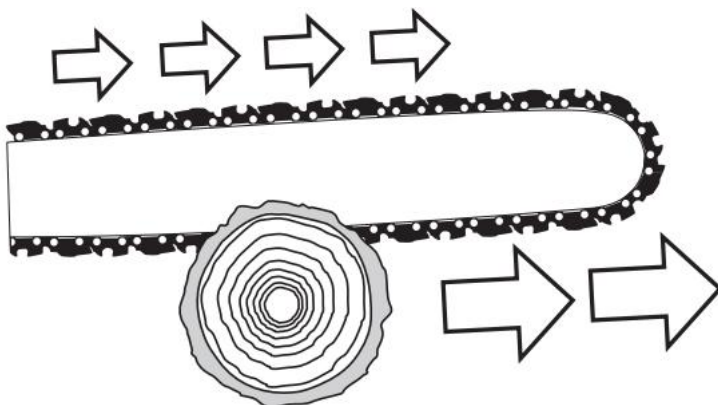

With this technique, sawing occurs with the underside of the saw bar from above downwards. The saw chain thus pushes the device forwards away from the user. This way, the front edge of the device forms a support, which catches the forces which arise on the tree trunk when sawing.

With pulling sawing, the user has much more control over the device and can avoid kickbacks better. Therefore, this is the preferred sawing technique.

### Pushing sawing

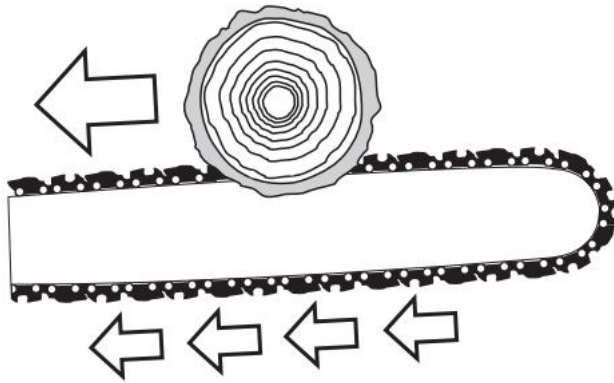

With this technique, sawing occurs with the upper edge of the saw bar from below upwards. The saw chain thus pushes the device backwards towards the user. If the saw bar twists, the device can fly towards the user with great force.

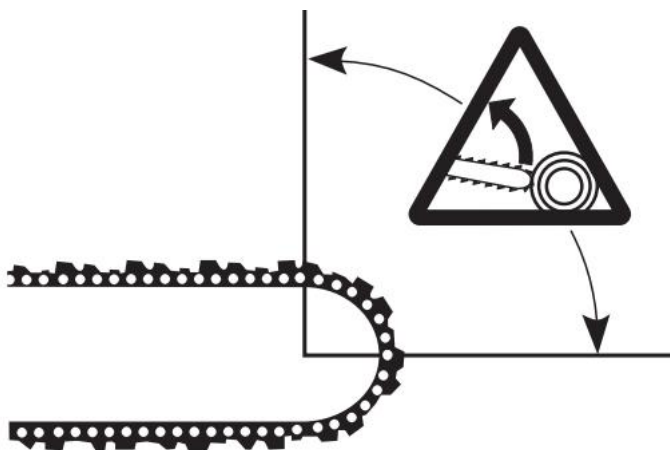

If the user does not balance out the force of the saw chain pushing backwards with his or her bodily force, there is a danger that only the tip of the saw bar will make contact with the wood and there will thus be a kickback (► *Risk of kickback!*).

### Removing branches



**WARNING! Risk of injury!** Tree cutting and delimbing work may only be performed by trained people!

There is  
a risk of fatal injury!

**WARNING! Risk of injury!** Branches that are high up or under tension can wedge the saw chain in the wood!

Before beginning the tree cutting work, make sure that:

- there are no people or animals in the felling area of the branches.
  - there is an obstacle-free escape route for each participant.
  - the area around the trunk is free of obstacles (risk of stumbling!).
- Always work on the side opposite the branch in question.

– Begin at the bottom of the trunk and work upwards.

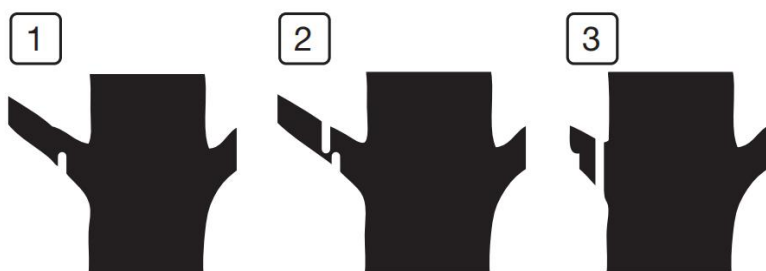

– When separating thicker branches, make the first cut from below [1]. Then cut through from above [2] and finally separate the remaining stump [3].

## Cleaning and maintenance



**WARNING! Risk of injury!** Before any maintenance or cleaning work:

- Remove the battery.
- Let the device cool down.

### Overview of cleaning

#### If necessary

What?	How?
Clean the machine	<ul style="list-style-type: none"> <li>– Remove coarse dirt.</li> <li>– Wipe down the device with a slightly damp cloth.</li> </ul>
Oil cutting tool	Clean cutting tool with brush. Then, spray oil on all sides of the cutting tool.

#### Annually

What?	How?
Re-tension saw chain	Lift the tip of the saw bar slightly. Tighten the tensioning screw for chain tension (24) until the chain lies on the underside of the saw bar (Fig.6).
Clean oil guide groove of the saw bar.	<p>Remove the saw bar. Clean dirt from the oil guide groove of the saw bar with a suitable tool. (plastic spatula, do not use any steel tools!)</p> <p>Replace saw bar (► <i>Assembling the saw bar and saw chain</i>)</p>
Sharpen the saw chain.	Special tools are required to sharpen the saw chain; these guarantee that the cutting of the chain occurs at the correct angle and the correct depth. We recommend that you have the saw chain sharpened by a professional.

## Storing, transport

### Storing



**WARNING! Danger of injury!** Make sure no unauthorized persons can gain access to the appliance!

- Slip the protection cover over the cutting equipment.
- Store the appliance where it is dry and well ventilated.

### Longer down-times

If you are not going to be using the device for a while, remove the chain oil from the device. Store the device in a dry place.

### Transportation

1. Switch the product off and remove the battery pack.
2. Attach the blade cover (13).
3. Always carry the product by its handle.
4. Protect the product from any heavy impact or strong vibrations which may occur during transportation in vehicles.
5. Secure the product to prevent it from slipping or falling over.

## Troubleshooting

Suspected malfunctions are often due to causes that the users can fix themselves. Therefore, check the product using this section. In most cases the problem can be solved quickly.



**WARNING!** Only perform the steps described within these instructions! All further inspection, maintenance and repair work must be performed by an authorized service center or a similarly qualified specialist if you cannot solve the problem yourself!

Problem	Possible cause	Solution
·Product does not start	·Battery pack not properly attached ·Battery pack discharged ·Battery pack damaged ·Electrical defect to the product	·Attach properly Remove and charge battery pack ·Replace with a new one of the same ·Check by a specialist electrician
·Product does not reach full power	·Low battery capacity ·Air vents are blocked	·Charge battery pack ·Clean the air vents
·Unsatisfactory result	·Blade is worn/damaged ·Thickness of branches exceeds capacity	·Replace with a new one ·Only cut branches complying with the capacity
·Excessive vibration or noise	·Blade is dull/damaged ·Bolts/nuts are loose	·Have it replaced with new one ·Tighten bolts/nuts

## Disposal



### Disposal of the appliance

A crossed-out wheeled bin icon means: Waste electrical products should not be disposed of with household waste. Please recycle where facilities exist. Check with your local authority or local store for recycling regulations.

- Do not dispose of electrical appliances as unsorted municipal waste. Use separate collection facilities.
- Contact your local government agency for information regarding the collection systems available.
- If electrical appliances are disposed of in landfills or dumps, hazardous substances can leak into the groundwater and get into the food chain, damaging your health and well-being.
- When replacing old appliances with new ones, the retailer is legally obligated to take back your old appliance for disposal at least free of charge. The product comes in a package that protects it against damage during shipping. Keep the package until you are sure that all parts have been delivered and the product is functioning properly. Recycle the package afterwards or keep it for long-term storage.



### Battery Caution + Disposal

**Always dispose of your battery pack according to federal, state, and local regulations. Contact a recycling agency in your area for recycling locations.**



**CAUTION! Even discharged battery packs contain some energy. Before disposing, use electrical tape to cover the terminals to prevent the battery pack from shorting, which could cause a fire or explosion.**

## Service + Support:

If power tool requires service or maintenance, please contact Sporty's Preferred Living customer service at 1-800-776-7897 or via email at [PreferredLiving@sportys.com](mailto:PreferredLiving@sportys.com)